



STUB AXLE & KING PIN BEARINGS

MEDWAY® Stub Axle and King Pin Bearings all have steel cages to reduce friction.

ZZ denotes bearing with 2 metal shields.

2RS denotes bearing with 2 rubber seals.

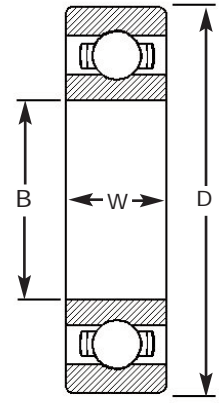

STANDARD

PART NO.	B	D	W
608ZZ	8	22	7
608/2RS	8	22	7
6000ZZ	10	26	8
6000/2RS	10	26	8
6001ZZ	12	28	8
6001/2RS	12	28	8
6202ZZ	15	35	11
6202/2RS	15	35	11
6003ZZ	17	35	10
6003/2RS	17	35	10
6203ZZ	17	40	12
6203/2RS	17	40	12

QUALITY

PART NO.	B	D	W
608ZZ	8	22	7
608/2RS	8	22	7
6000ZZ	10	26	8
6000/2RS	10	26	8
6001ZZ	12	28	8
6001/2RS	12	28	8
6202ZZ	15	35	11
6202/2RS	15	35	11
6003ZZ	17	35	10
6003/2RS	17	35	10
6203ZZ	17	40	12
6203/2RS	17	40	12



TRACK ROD ENDS

MEDWAY® Rod Ends are manufactured in the U.K. by **MEDWAY POWER TRANSMISSION LTD.** at our own manufacturing facility. We can also produce special products to suit individual requirements.

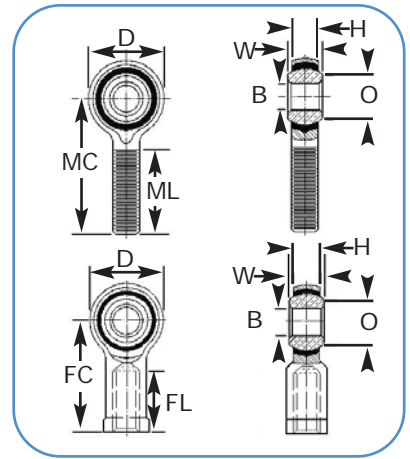

MALE

PART NO. RIGHT HAND	B	THREAD	W	H	D	ML	MC	O	STATIC LOAD RATING (NEWTONS)
MP-M06	6	M6/1.0	9	6.75	18	22	36	9.3	7,720
MPL-M06	6	M6/1.0	9	6.75	18	22	36	9.3	7,720
MP-M08	8	M8/1.25	12	9.00	22	25	42	10.4	12,775
MPL-M08	8	M8/1.25	12	9.00	22	25	42	10.4	12,775
MP-M10	10	M10/1.5	14	10.50	26	29	48	12.9	16,960
MPL-M10	10	M10/1.5	14	10.50	26	29	48	12.9	16,960
MP-M12	12	M12/1.75	16	12.00	30	33	54	15.4	22,900
MPL-M12	12	M12/1.75	16	12.00	30	33	54	15.4	22,900
MP-04	1/4	1/4-28	0.375	0.281	0.750	1.000	1.562	0.354	8,450
MPL-04	1/4	1/4-28	0.375	0.281	0.750	1.000	1.562	0.354	8,450
MP-06	3/8	3/8-24	0.500	0.406	1.000	1.250	1.938	0.516	16,900
MPL-06	3/8	3/8-24	0.500	0.406	1.000	1.250	1.938	0.516	16,900
MP-08	1/2	1/2-20	0.652	0.500	1.312	1.500	2.438	0.700	28,900
MPL-08	1/2	1/2-20	0.652	0.500	1.312	1.500	2.438	0.700	28,900

FEMALE

PART NO. RIGHT HAND	B	THREAD	W	H	D	FL	FC	O	STATIC LOAD RATING (NEWTONS)
FP-M06	6	M6/1.0	9	6.75	18	14	30	9.3	7,720
FPL-M06	6	M6/1.0	9	6.75	18	14	30	9.3	7,720
FP-M08	8	M8/1.25	12	9.00	22	17	36	10.4	12,775
FPL-M08	8	M8/1.25	12	9.00	22	17	36	10.4	12,775
FP-M10	10	M10/1.5	14	10.50	26	21	43	12.9	16,960
FPL-M10	10	M10/1.5	14	10.50	26	21	43	12.9	16,960
FP-M12	12	M12/1.75	16	12.00	30	30	24	50	22,900
FPL-M12	12	M12/1.75	16	12.00	30	30	24	50	22,900
FP-04	1/4	1/4-28	0.375	0.281	0.750	0.750	1.375	0.447	12,000
FPL-04	1/4	1/4-28	0.375	0.281	0.750	0.750	1.375	0.447	12,000
FP-06	3/8	3/8-24	0.500	0.406	1.000	0.937	1.625	0.516	16,900
FPL-06	3/8	3/8-24	0.500	0.406	1.000	0.937	1.625	0.516	16,900
FP-08	1/2	1/2-20	0.652	0.500	1.312	1.187	2.125	0.700	28,910
FPL-08	1/2	1/2-20	0.652	0.500	1.312	1.187	2.125	0.700	28,910

MP-M06 = RIGHT HAND
MPL-M06 = LEFT HAND

FP-08 = RIGHT HAND
FPL-08 = LEFT HAND

AXLE BEARINGS

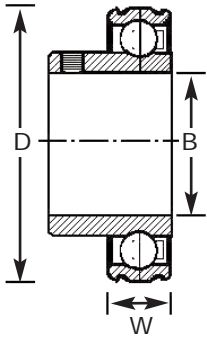

MEDWAY® Axle Bearings with EC denotes eccentric locking collar. Axle Bearings without EC denotes they have 2 grub screws for locking. ZZ denotes bearing with 2 metal shields. 2RS denotes bearing with 2 rubber seals.



25MM

PART NO.	B	D	W
B5/25ZZ	25	52	15
B5/25ZZ/EC	25	52	15
B5/25/2RS	25	52	15
B5/25/2RS/EC	25	52	15
B6/25ZZ	25	62	16

30MM

B6/30ZZ	30	62	16
B6/30ZZ/EC	30	62	16
B6/30/2RS	30	62	16
B6/30/2RS/EC	30	62	16
B7/30ZZ	30	72	17
1230/30ZZVPO76(SKF)	30	62	16

35MM

B7/35ZZ	25	72	17
B7/35ZZ/EC	25	72	17
B7/35/2RS	25	72	17
B7/35/2RS/EC	25	72	17
B8/35ZZ	25	80	18

40MM

B8/40ZZ	40	80	18
B8/40ZZ/EC	40	80	18
B8/40/2RS	40	80	18
B8/40/2RS/EC	40	80	18

50MM

B8/50ZZ	50	80	18
---------	----	----	----

MISCELLANEOUS

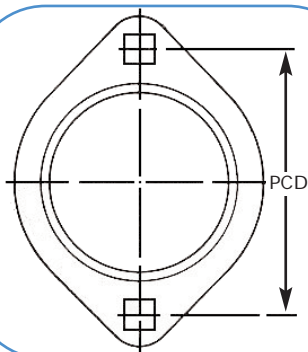

Where indicated flange dimensions shown in (brackets).

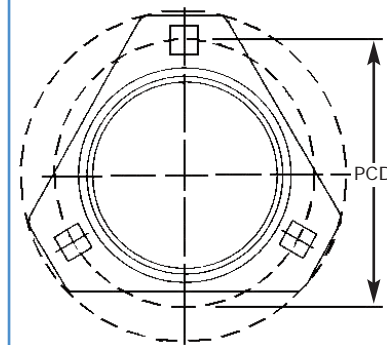

PLATES

PART NO.	B	PCD	HOLES
PFL5	52	76	2
PFT5	52	76	3
PFL6	62	90.5	2
PFT6	62	90.5	3

GRUBSCREWS

PART NO.	THREAD	LENGTH	MINIMUM ORDER QTY.
M6X0.75GS	M6X0.75	6	20
M6X1.00GS	M6X1.00	6	20
M8X1.00GS	M8X1.00	8	20

MISCELLANEOUS BEARINGS

PART NO.	B	D	W
30202	15	35	11.75
30203	17	40	13.25
6008/2RS/NS7S	40	68	15
RAX720	20	26 (36.5)	18.2 (4.2)
CP2035	20	35	0.80

STEERING COLUMN BEARINGS

PART NO.	B	D	W
JBS8	8	22	7.9
JBS10	10	26	9.5

CIRCLIPS

PART NO.	TYPE	DESCRIPTION
1300/22MM	INTERNAL	22MM TO SUIT JBS8
1300/26MM	INTERNAL	26MM TO SUIT JBS10
1400/25MM	EXTERNAL	25MM TO SUIT 25MM AXLE
1400/30MM	EXTERNAL	30MM TO SUIT 30MM AXLE

DRIVE BELTS

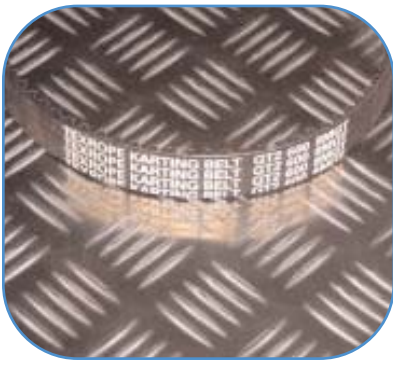

5MM PITCH

GT2® Karting Belts are manufactured by TEXROPE and are made of a high advanced compound of new materials that produces an increased load carrying power, this new generation of belt is supplied exclusively by **MEDWAY POWER TRANSMISSION LTD.**

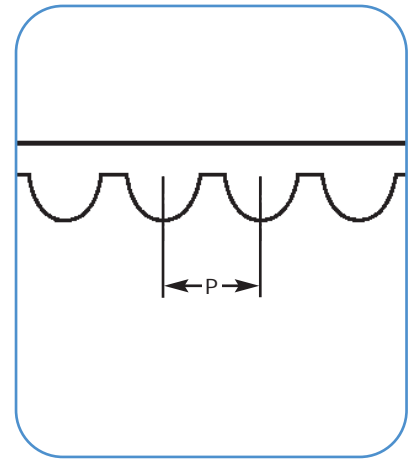

PART NO.	NO. OF TEETH	PITCH (P)	BELT WIDTH (W)
800-5MR-25	160	5	25
890-5MR-25	178	5	25
950-5MR-25	190	5	25
1000-5MR-25	200	5	25

8MM PITCH

PART NO.	NO. OF TEETH	PITCH (P)	BELT WIDTH (W)
600-8MGT2-30	75	8	30
640-8MGT2-30	80	8	30
680-8MGT2-30	85	8	30
720-8MGT2-30	90	8	30
800-8MGT2-30	100	8	30
840-8MGT2-30	105	8	30
600-8MGT2-50	75	8	50
640-8MGT2-50	80	8	50
680-8MGT2-50	85	8	50
720-8MGT2-50	90	8	50
800-8MGT2-50	100	8	50
840-8MGT2-50	105	8	50



DRIVE BELT PULLEYS

MEDWAY® Front Pulleys are made of steel or cast iron and are machined to suit your engine shaft size, either bored & keyed or taper bush fitting.

Rear Pulleys are manufactured in aluminium and have fixing holes to suit standard hub and sprocket carriers.

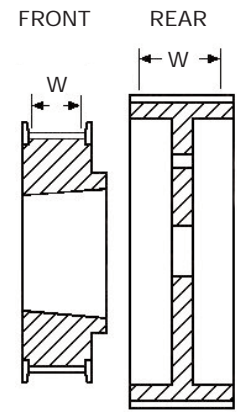

5MM PITCH

PART NO.	NO. OF TEETH	FRONT / REAR	BELT WIDTH (W)
22-5M-25F	22	F	25
24-5M-25F	24	F	25
26-5M-25F	26	F	25
28-5M-25F	28	F	25
30-5M-25F	30	F	25
130-5M-25K	130	R	25
135-5M-25K	135	R	25
140-5M-25K	140	R	25
145-5M-25K	145	R	25
150-5M-25K	150	R	25

8MM PITCH

PART NO.	NO. OF TEETH	FRONT / REAR	BELT WIDTH (W)
22-8M-30F	22	F	30
24-8M-30F	24	F	30
26-8M-30F	26	F	30
28-8M-30F	28	F	30
30-8M-30F	30	F	30
22-8M-50F	22	F	50
24-8M-50F	24	F	50
26-8M-50F	26	F	50
28-8M-50F	28	F	50
30-8M-50F	30	F	50
50-8M-30K	50	R	30
60-8M-30K	60	R	30
70-8M-30K	70	R	30
80-8M-30K	80	R	30
90-8M-30K	90	R	30
50-8M-50K	50	R	50
60-8M-50K	60	R	50
70-8M-50K	70	R	50
80-8M-50K	80	R	50
90-8M-50K	90	R	50

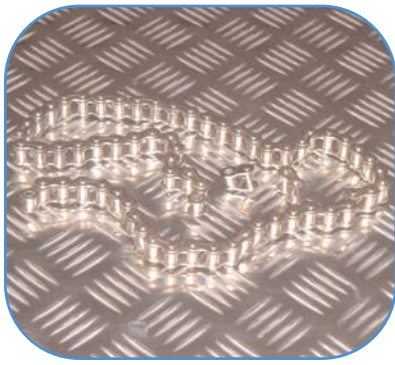

ROLLER CHAIN

Roller Chain is available in both British and American Standards with both connecting links and half links also available.

CL Denotes CONN LINK
OL Denotes HALF LINK

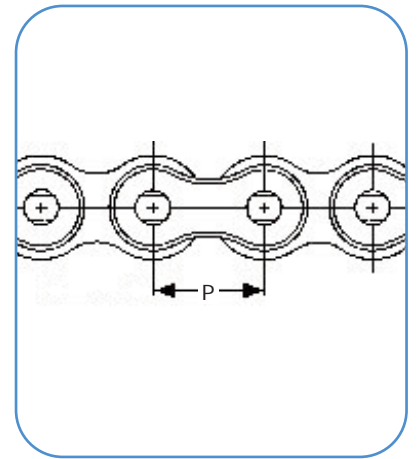

STANDARD

PART NO.	PITCH (P)	DESCRIPTION
06B-1	3/8" BRITISH STD	MEDWAY®
06B-1CL		CONN-LINK
06B-1OL		HALF-LINK
08B-1	1/2" BRITISH STD	MEDWAY®
08B-1CL		CONN-LINK
08B-1OL		HALF-LINK
ASA35-1	3/8" AMERICAN STD	MEDWAY®
ASA35-1CL		CONN-LINK
ASA35-1OL		HALF-LINK
ASA40-1	1/2" AMERICAN STD	MEDWAY®
ASA40-1CL		CONN-LINK
ASA40-1OL		HALF-LINK
ASA41-1	1/2" AMERICAN STD	MEDWAY®
ASA41-1CL		CONN-LINK
ASA41-1OL		HALF-LINK

QUALITY

PART NO.	PITCH (P)	DESCRIPTION
D-06B-1	3/8" BRITISH STD	DIAMOND
D-06B-1CL		CONN-LINK
D-06B-1OL		HALF-LINK
D-08B-1	1/2" BRITISH STD	DIAMOND
D-08B-1CL		CONN-LINK
D-08B-1OL		HALF-LINK
D-ASA35-1	3/8" AMERICAN STD	DIAMOND
D-ASA35-1CL		CONN-LINK
D-ASA35-1OL		HALF-LINK
D-ASA40-1	1/2" AMERICAN STD	DIAMOND
D-ASA40-1CL		CONN-LINK
D-ASA40-1OL		HALF-LINK
D-ASA41-1	1/2" AMERICAN STD	DIAMOND
D-ASA41-1CL		CONN-LINK
D-ASA41-1OL		HALF-LINK
428/O-RING	1/2" O-RING	REGINA

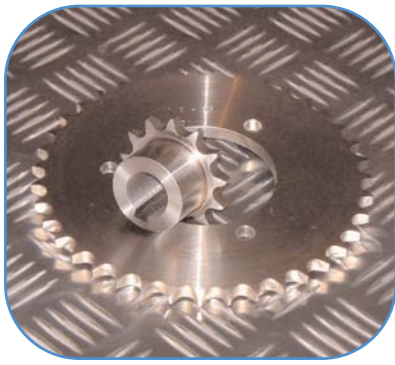

ROLLER CHAIN SPROCKETS

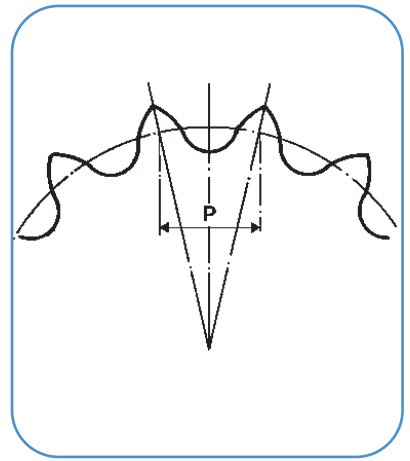

FRONT SPROCKETS

MEDWAY® Front Sprockets are finished and machined to suit your engine shaft size. Rear Sprockets are machined with fixing holes to suit standard hub and Sprocket carriers, all Sprockets are manufactured in steel.

PART NO.	PITCH (P)	NO. OF TEETH
PB428/12	1/2"	12
PB428/13	1/2"	13
PB428/14	1/2"	14
PB428/15	1/2"	15
PB428/16	1/2"	16
PB428/17	1/2"	17
PB428/18	1/2"	18
PB428/19	1/2"	19
PB428/20	1/2"	20

REAR SPROCKETS

PART NO.	PITCH (P)	NO. OF TEETH
PW428/38	1/2"	38
PW428/39	1/2"	39
PW428/40	1/2"	40
PW428/41	1/2"	41
PW428/42	1/2"	42
PW428/43	1/2"	43
PW428/44	1/2"	44
PW428/45	1/2"	45
PW428/46	1/2"	46
PW428/47	1/2"	47
PW428/48	1/2"	48
PW428/49	1/2"	49
PW428/50	1/2"	50
PW428/51	1/2"	51
PW428/52	1/2"	52
PW428/53	1/2"	53
PW428/54	1/2"	54
PW428/55	1/2"	55
PW428/56	1/2"	56
PW428/57	1/2"	57
PW428/58	1/2"	58
PW428/59	1/2"	59
PW428/60	1/2"	60

CONVERSION TABLES

MM TO INCH

NEWTONS TO POUNDS (N TO lbs)

MM	INCH		MM	INCH	MM	INCH
1.000	0.039		25.40	1.000	73.00	2.874
1.587	0.062	1/16	26.00	1.0241	74.00	2.913
1.984	0.078	5/64	27.00	1.063	75.00	2.953
2.000	0.079		28.00	1.102	76.00	2.992
2.381	0.094	7/64	28.575	1.125	76.20	3.000
3.000	0.118		29.00	1.142	77.00	3.031
3.175	0.125	1/8	30.00	1.181	78.00	3.071
3.572	0.141	9/64	31.00	1.220	79.00	3.110
3.969	0.156	5/32	31.750	1.250	80.00	3.150
4.000	0.158		32.00	1.260	81.00	3.189
4.366	0.172	11/64	33.00	1.299	82.00	3.228
4.762	0.187	3/16	34.00	1.339	82.55	3.250
5.000	0.197		34.925	1.375	83.00	3.268
5.566	0.219	7/32	35.00	1.378	84.00	3.307
6.000	0.236		36.00	1.417	85.00	3.346
6.350	0.250	1/4	37.00	1.457	86.00	3.386
7.000	0.276		38.00	1.496	87.00	3.425
7.144	0.281	9/32	38.10	1.500	88.00	3.465
7.937	0.312	5/16	39.00	1.535	88.90	3.500
8.000	0.315		40.00	1.575	89.00	3.504
8.731	0.344	11/32	41.00	1.614	90.00	3.543
9.000	0.354		41.275	1.625	91.00	3.583
9.128	0.359	23/64	42.00	1.653	92.00	3.622
9.525	0.375	3/8	43.00	1.693	93.00	3.661
10.000	0.394		44.00	1.732	94.00	3.701
10.319	0.406	13/32	44.45	1.750	95.00	3.740
11.000	0.433		45.00	1.772	95.25	3.750
11.112	0.437	7/16	46.00	1.811	96.00	3.779
11.509	0.453	29/64	47.00	1.850	97.00	3.819
11.906	0.469	15/32	47.625	1.875	98.00	3.858
12.000	0.472		48.00	1.890	99.00	3.898
12.700	0.500	1/2	49.00	1.929	100.0	3.937
13.000	0.512		50.00	1.968	101.6	4.000
13.494	0.531	17/32	50.80	2.000	110.0	4.331
14.000	0.551		51.00	2.008	114.3	4.500
14.287	0.562	9/16	52.00	2.047	120.0	4.724
15.000	0.590		53.00	2.087	127.0	5.000
15.081	0.594	19/32	54.00	2.126	130.0	5.118
15.875	0.625	5/8	55.00	2.165	139.7	5.500
16.000	0.630		56.00	2.205	140.0	5.512
16.669	0.656	21/32	57.00	2.244	150.0	5.905
17.000	0.669		57.70	2.250	152.4	6.000
17.462	0.687	11/16	58.00	2.283	160.0	6.299
18.000	0.709		59.00	2.323	165.1	6.500
18.256	0.719	23/32	60.00	2.362	170.0	6.693
19.000	0.748		61.00	2.402	177.8	7.000
19.050	0.750	3/4	62.00	2.441	180.0	7.087
19.844	0.781	25/32	63.00	2.480	190.0	7.480
20.000	0.787		63.50	2.500	190.5	7.500
20.637	0.812	13/16	64.00	2.520	200.0	7.874
21.000	0.827		65.00	2.559	203.2	8.000
21.431	0.844	27/32	66.00	2.598	210.0	8.268
22.000	0.866		67.00	2.638	215.9	8.500
22.225	0.875	7/8	68.00	2.677	220.0	8.661
23.000	0.905		69.00	2.716	228.6	9.000
23.815	0.937	15/16	69.85	2.750	230.0	9.055
24.000	0.945		70.00	2.756	240.0	9.449
24.606	0.969	31/32	71.00	2.795	241.3	9.500
25.000	0.984		72.00	2.835	250.0	9.842

N	lbs	N	lbs	N	lbs	N	lbs
10.0	2.25	355.8	80.0	4448	1,000	60,000	13,490
20.0	4.50	400.0	90.0	5,000	1,124	70,000	15,740
30.0	6.75	444.8	100.0	6,000	1,349	80,000	17,990
40.0	9.00	500.0	112.4	7,000	1,574	88,960	20,000
44.48	10.00	600.0	134.9	8,000	1,799	90,000	20,230
50.0	11.24	700.0	157.4	8,896	2,000	100,000	22,500
60.0	13.49	800.0	179.9	9,000	2,032	133,440	30,000
70.0	15.74	889.6	200.0	10,000	2,250	177,920	40,000
80.0	17.99	900.0	202.3	13,344	3,000	200,000	45,000
88.96	20.00	1,000	225.0	17,792	4,000	222,400	50,000
90.0	20.23	1,334.4	300.0	20,000	4,500	266,880	60,000
100.0	22.50	1,779.2	400.0	22,240	5,000	300,000	67,500
133.44	30.00	2,000	450.0	26,688	6,000	311,360	70,000
177.92	40.00	2,224	500.0	30,000	6,750	355,840	80,000
200.0	45.00	2,668.8	600.0	31,136	7,000	400,000	90,000
222.40	50.00	3,000	675.0	35,584	8,000	444,800	100,000
266.88	60.00	3,113.6	700.0	40,000	9,000	500,000	112,400
300.0	67.50	3558.4	800.0	44,480	10,000		
311.36	70.00	4,000	900.0	50,000	11,240		
TORQUE CONVERSION (Nm TO lbs/in)							
Nm	lbs/in	Nm	lbs/in	Nm	lbs/in	Nm	lbs/in
0.03	0.25	0.23	2.00	0.68	6.00	1.69	15.00
0.04	0.35	0.25	2.22	0.80	7.09	1.81	16.00
0.05	0.44	0.30	2.66	0.90	8.00	2.00	17.72
0.06	0.50	0.34	3.00	1.00	8.86	2.71	24.00
0.08	0.71	0.40	3.54	1.13	10.00	3.00	26.58
0.10	0.89	0.50	4.43	1.20	10.63	3.50	31.01
0.11	1.00	0.56	5.00	1.35	12.00	5.00	44.30
0.20	1.77	0.60	5.32	1.50	13.29		